

# LD Flexi

IP68 Flexible 24V Linear LED



Data sheet - Page 1



LD Flexi is a robust, very shallow, IP68 rated flexible 24V linear LED product. Ideal for a range of architectural applications such as step details. LD Flexi is not intended for permanent underwater use.

**Please note colour shift:** Due to the resin being in contact with the LED there is a colour shift of around 600K to a cooler white colour temperature. This means the warmest white we can supply is 3000K which uses 2400K LED tape.

## Key Features

- Choice of LED outputs depending on the application, including RGB
- Specially designed PVC extrusion which is robust but very flexible with excellent resistance to chemical attack
- LEDs are encapsulated in an optically clear UV resistant polyurethane resin
- Fixing is by stainless steel fixing clips, with a choice of two depending on the installation detail
- LD Flexi only bends in the vertical plane (around the thinnest side), to a minimum bend radius of 200mm
- Lengths are custom made to suit to a maximum of 3015mm\*\*
- Available with Switched, 1-10V, DMX or Dali drivers

## Dimensions

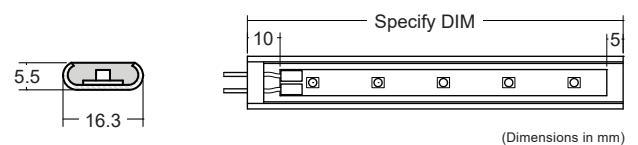

# LD Flexi



IP68 Flexible 24V Linear LED

Data sheet - Page 2

LED output options	Eco 220 lm/m		Short 800 lm/m		RGB ECO 180 lm/m
Applications					
	<p>Highlighting architectural details, steps</p>		<p>Same applications as Eco but with increased output and closer pitch LEDs</p>		<p>Colour change</p>
Description	Eco output tape		Short pitch tape		RGB tape
Colour Temperature*	3300K (2700K)*	4600K (4000K)*	3000K (2400K)* / 3300K (2700K)* / 3600K (3000K)*	4600K (4000K)* / 5600K (5000K)*	-
CRI	80+				-
Delivered lumens / m	220lm/m	240lm/m	800lm/m	850lm/m	180lm/m
Watts / m	3.6W/m		8.7W/m		6.5W/m
Lumens per watt	61lm/w		92lm/w	98lm/w	-
LED cut increments	100mm		50mm		150mm
LED spacing	20mm		8.3mm		30mm
Min single length	115mm		65mm		165mm
Max single length**	3015mm		3015mm		3015mm
LED	Osram Flex				
Voltage (V)	24V DC				
LED lifetime	50,000hrs (to 70% lumen output)				
Max ambient temperature	45°C				30°C
Minimum bend radius	200mm				
Materials	LD Flexi - PVC extrusion, polyurethane resin, polycarbonate end cap. Fixing clips - stainless steel.				
Cable length	2m (can be specified with up to 10m at extra cost)				
IP rating	IP68 - Not for permanent submersion				

\* Resin used within the LD Flexi causes a 600K shift. Bracketed temperature indicates reading before colour shift.

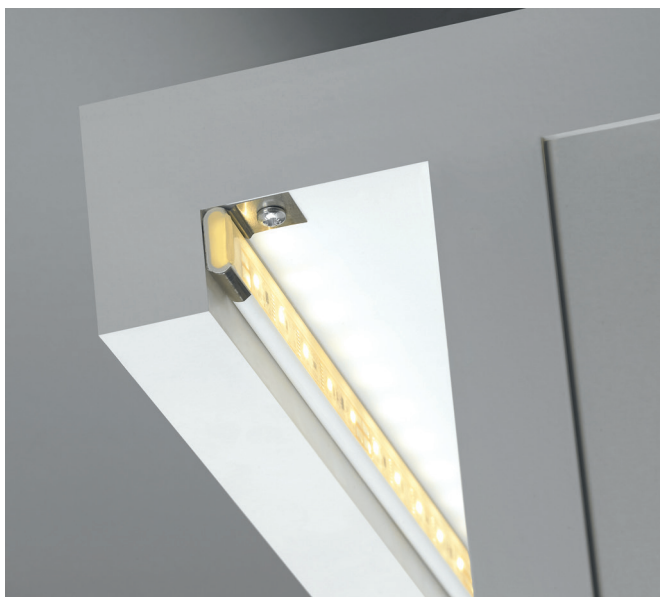

### Fixing options

/FFC - Flat fixing clip

/AFC - Angled fixing clip

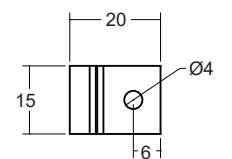
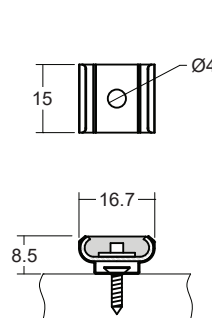

(Dimensions in mm)

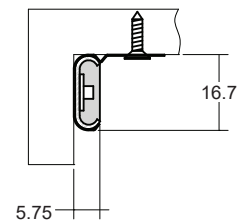

# LD Flexi

IP68 Flexible 24V Linear LED



Data sheet - Page 3

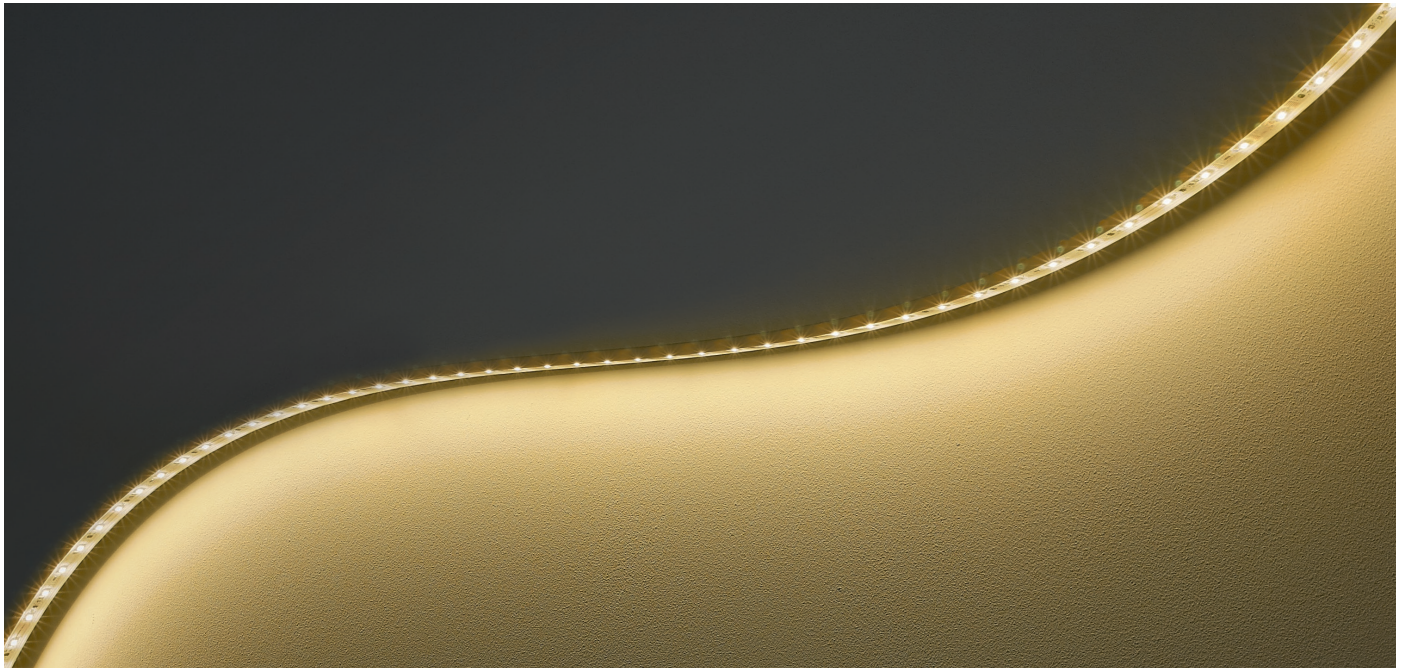

## Suggested mounting details

We recommend the distances shown below when mounting multiple lengths end to end to ensure a continuous wash of light.

Angled fixing clip

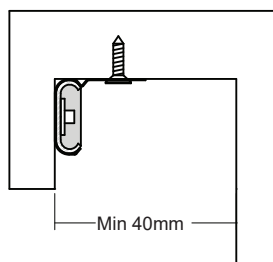

Flat fixing clip

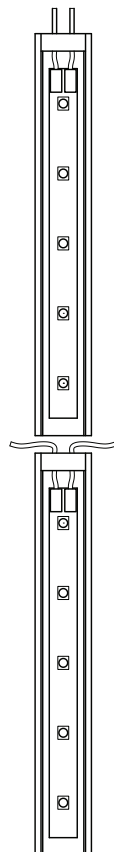
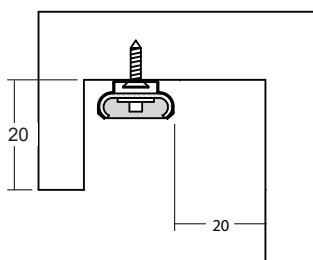

## Photometrics

Photometric files are included in the design pack which can be downloaded from the LD Flexi product page on the website.

## Order Codes and Options

Product code	LED	LED colour	Fixing option	Length
LD Flexi	<input type="text"/>	<input type="text"/>	<input type="text"/>	<input type="text"/>

Example: LDFlexi / Eco / LW33 / AFC / 2000mm

LED output options	Suffix
Eco	/Eco
Short	/Short
RGB-ECO	/RGB-ECO
LED colour options	
Warm White (3000K)	/LW30
Warm White (3300K)	/LW33
White (3600K)	/LW36
Cool White (4600K Eco)	/LW46
Cool White (5600K Short)	/LW56
Fixing options	
Angled fixing clip	/AFC
Flat fixing clip	/FFC
(3 fixing clips supplied per metre)	

### To be used with 24V constant voltage LED Drivers and Controllers

We offer a range of drivers with 1-10V, DMX, and DALI dimming options. Please download the data sheet from the downloads section at [www.lightgraphix.co.uk](http://www.lightgraphix.co.uk), or contact us for more information